

# Microfine

## Permanent Magnetic Chucks

The Microfine is an extremely economical Permanent Magnetic Chuck which can be manually switched.

It has a very flat magnetic field and is suitable for grinding and EDM.

It is used for our Microsine.

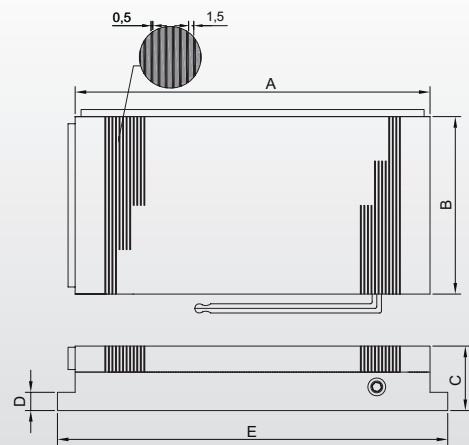
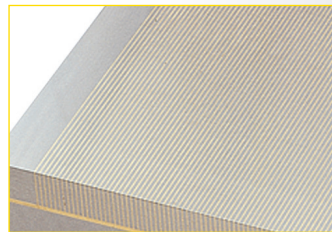
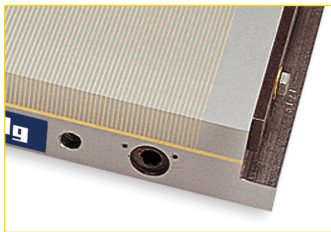

### Application

- ▶ Universal use, especially for grinding and EDM, but also for finish milling
- ▶ Especially for small and thin, but also for thick workpieces if surface is clean and even

### Features

- Ⓢ Design with low height, but high adhesive force
- Ⓢ The contact surface can be machined up to 2mm and drilled up to max. 8 mm depth
- Ⓢ Liquid-tight
- Ⓢ Can be switched ON/OFF mechanically
- Ⓢ Workpieces can be clamped stress-free and fast
- Ⓢ 5-side processing, as only one side is magnetically clamped
- Ⓢ Low magnetic penetration depth because of a flat magnetic field due to fine pole pitch – not very good for bridging air gaps
- Ⓢ Adhesive force: 80 N/cm<sup>2</sup> with pole pitch 1.5 + 0.5 mm

### Technical data

	Dimensions [mm]					Weight	No.
	A	B	C	D	E	[kg]	
MF 1510	150	100	48	16	170	5	41731
MF 2512	250	125	48	16	270	11	41732
MF 3015	300	150	48	16	320	16	41733
MF 3515	350	150	48	16	370	18	1969
MF 4515	450	150	53	16	470	24	5093
MF 3020	300	200	53	16	320	22	17007
MF 4020	400	200	53	16	420	30	22221
MF 5020	500	200	53	16	520	37	39408
MF 5025	500	250	53	16	520	47	33730
MF 6030	600	300	58	16	620	76	32502